



BINLEY FARMHOUSE

Binley, Andover, Hampshire, SP11 6HA

TO LET

£2,000 PCM



Binley Farmhouse

Binley, Andover, Hampshire, SP11 6HA

Attractive period farmhouse with 4 bedrooms, set in a peaceful village location.

THE PROPERTY

The house is located in the quiet village of Binley, surrounded by beautiful open countryside yet within easy reach of both Whitchurch and Andover for facilities.

Entering into a large, welcoming entrance hall with wooden floors, off which is the kitchen and dining room which is well fitted, with boot room and utility room. The sitting room on the opposite side of the hall is a large room with feature open fireplace. Finally there is the snug which is a cosy room with inglenook fireplace, and a cellar.

On the first floor, the master bedroom is a large, light double room with en-suite shower room. Bedroom 2 is another large double bedroom with built in cupboards to the front of the house. There are two further bedrooms and a large family bathroom.

Outside, there is ample parking and a useful outbuilding. The garden is an attractive space, with raised beds and leading to a large lawn area with rural views beyond.

ADDITIONAL INFORMATION

Services

Mains electricity
Oil fired central heating
Private water and sewerage
Mobile phone coverage limited (according to Ofcom)
Full fibre broadband available (according to Openreach)

EPC

E39

Local Authority

Basingstoke and Deane Borough Council, band E

Pets

Pets considered, rent may vary

Deposit

Total deposit: £2,884
Holding deposit: £576

Directions

From the centre of Whitchurch, proceed onto Bell Street, and follow this road out of the town, passing under a road bridge and onto Boswood Lane. As the



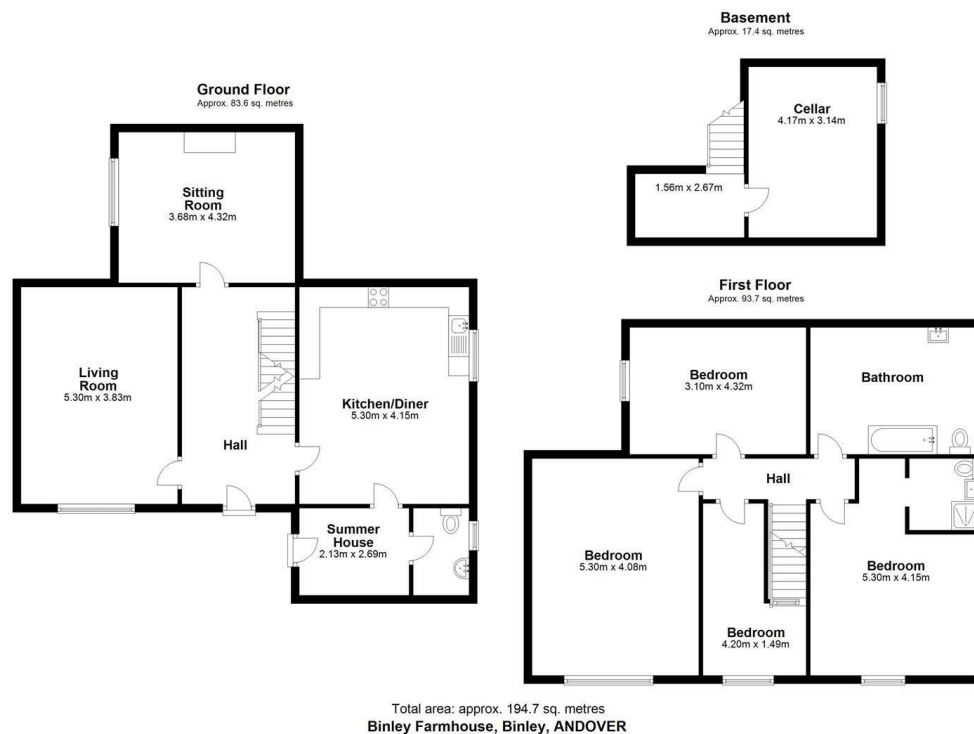

IMPORTANT NOTICE

BCM Wilson Hill for themselves and the Landlord give notice that:

1: These particulars have been prepared in good faith to give a fair overall view of the property, do not form any part of an offer or contract, and must not be relied upon as statements or representations of fact

2: Applicants must rely on their own enquiries by inspection or otherwise on all matters

3: The information in these particulars is given without responsibility on the part of BCM Wilson Hill or their clients. Neither BCM Wilson Hill nor their employees have any authority to make or give any representations or warranties in relation to this property

4: Any areas, measurements or distances referred to are given as a guide only and are not precise. Photographs are not necessarily comprehensive nor current; no assumption should be made that any contents shown are include in the let nor with regards to parts of the property which have not been photographed

5: Nothing in these particulars should be deemed to be a statement that the property is in good structural condition or that any services or equipment are in good working order- nor have BCM Wilson Hill tested them

road bends to the left, and the bottom of the hill, just past a pair of cottages, take the second right to St. Mary Bourne. Follow this lane, and after a sharp left hand bend, take the next turning right. Take the next left turning, and then at the end of that lane turn right. Take the next left and follow the lane down into Binley. On entering the village, bear left and Binley Farmhouse will be found on the left hand side. What3words ///lance.stunt.stripped

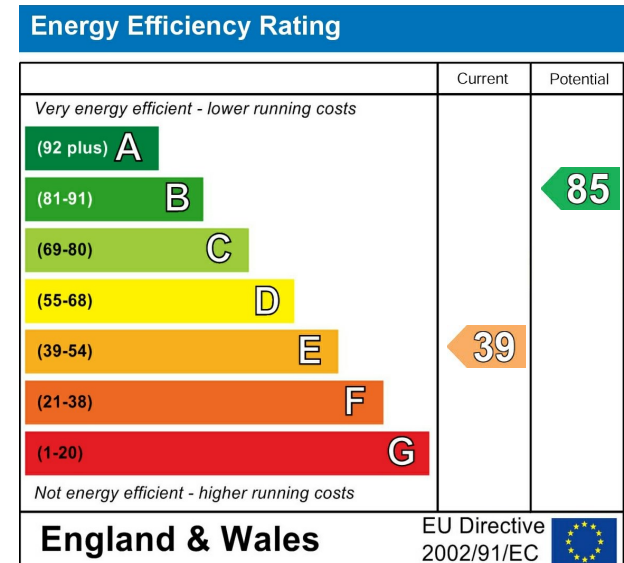

Lettings

01962 763908

lettings@bcmwilsonhill.co.uk

Offices at: Winchester | Petersfield | Isle of Wight | Oxford

bcmwilsonhill.co.uk